

INSTRUCTION MANUAL

MS600

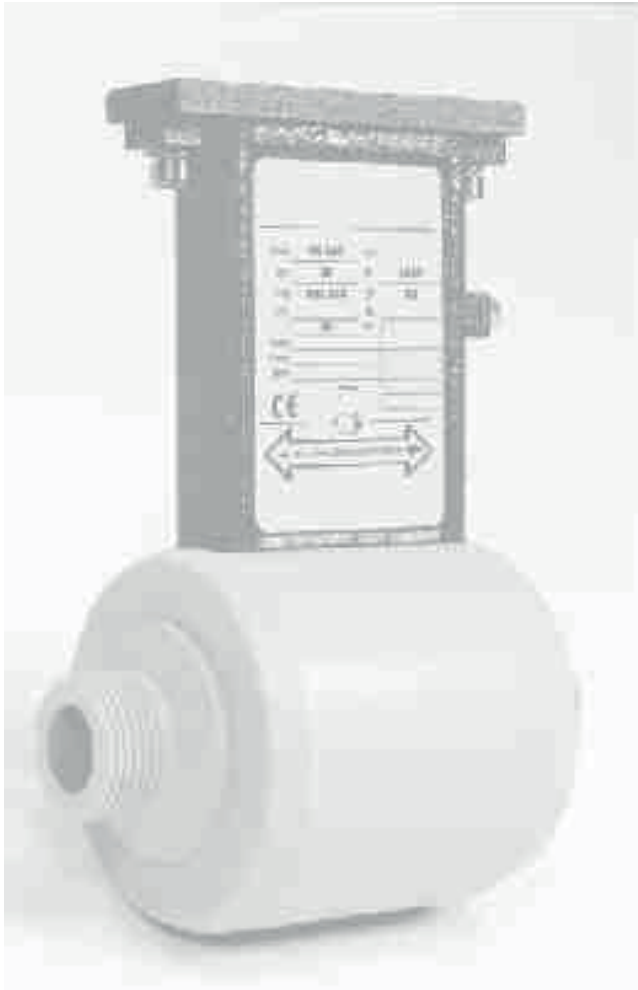

CE

INDEX

| | |
|--|----------------|
| START UP AND MAINTENANCE OF THE INSTRUMENTS | _____ 1 |
| INTRODUCTION | _____ 1 |
| SAFETY | _____ 2 |
| GENERAL INFORMATION ON THE SENSORS INSTALLATION | _____ 2 |
| OVERALL DIMENSIONS | _____ 4 |
| GROUNDING INSTRUCTIONS | _____ 5 |
| OPERATIVE TEMPERATURE | _____ 5 |

INTRODUCTION

- This manual is integral part of the product. Read carefully the instructions contained since it contains important indications for the safety of use and of maintenance.
- The technical information and the relative products of this manual could be modified without any previous notice.
- The flow meter must be used for the use it has been built for. The improper use, possible tampering of the instrument or parts of it and substitutions of any components not original, makes the warranty to decay automatically.
- The manufacturer is considered responsible only if the instrument is used in its original configuration and setting.
- The flowmeter makes measures of liquids with conductivity greater than $5\mu\text{S}/\text{cm}$; it consists of a sensor (described in this manual) and a converter, for it see the manual provided.
- If the sensor is supplied in compact version to the converter, consider the operating temperatures more restrictive, otherwise refer to the respective manuals (page 5).
- When transporting, unpacking and handling the flowmeter, be careful and care.
- In the case of prolonged storage and of transport, use and store in the original container in a dry place, do not place more than 3 packs one above the other.
- It is possible pallets storage and transport (in case of wooden crates do not place one above the other).
- For the cleaning of the device use only a damp cloth, and for the maintenance/repairs, contact the customer service.
- For the disposal of the device and of the packaging make strict reference to the regulations
- It is forbidden the reproduction of the present manual and of possible software supplied with the instrument.

START UP AND MAINTENANCE OF THE INSTRUMENTS

- Before starting up the instrument, always make a sure connection to ground as suitable to page 5.
- Verify periodically: the cables integrity, the tightening of the sealing elements (cable glands, covers, etc.), the mechanical fixing of the instrument on the pipe or on the wall stand

SAFETY



Before using the instrument, always make a sure connection to the ground



Avoid any attempt to repair the instrument. If the instrument is not functioning properly, please call the nearest assistance service



Pay maximum attention during the operations



ATTENTION !!!



DANGER !!!

GENERAL INFORMATION ON THE SENSORS INSTALLATION

FLOW DIRECTION

Before install the sensor locate the direction of the liquid in the piping

The sign of the flow rate is positive, when the flow direction is from – to + as printed on the tag plate.

If after the installation, for plant request becomes necessary reverse the sign of the flow, it is enough reverse the sign of the coefficient KA

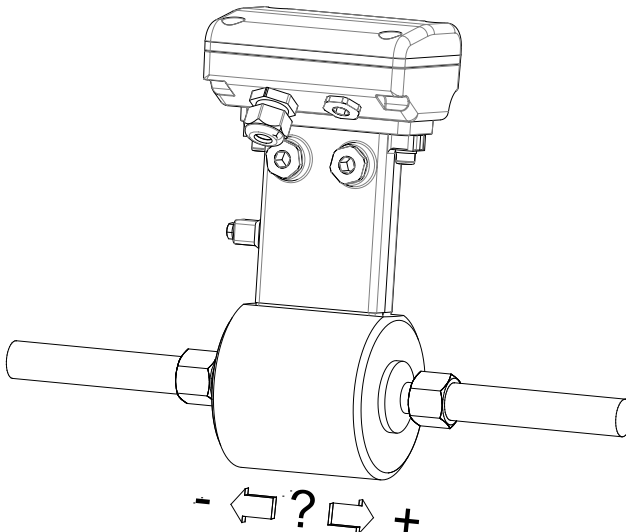

SHREWDNESS AND PRECAUTIONS

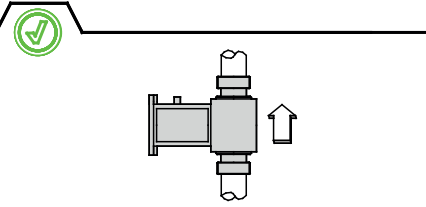
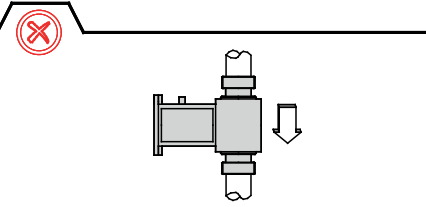
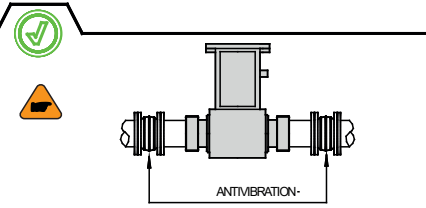
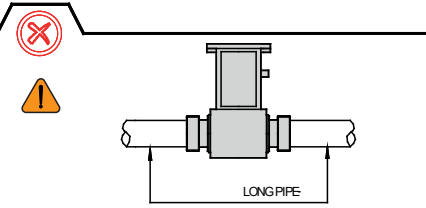
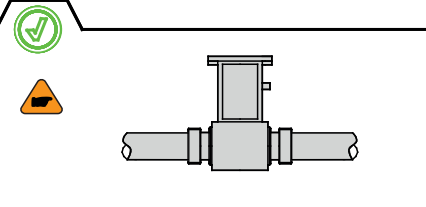
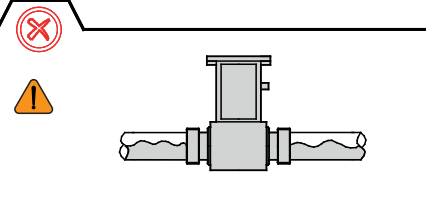
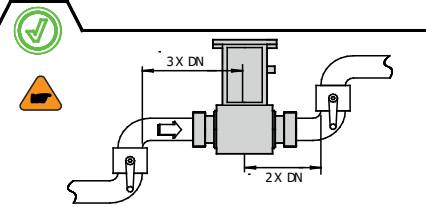
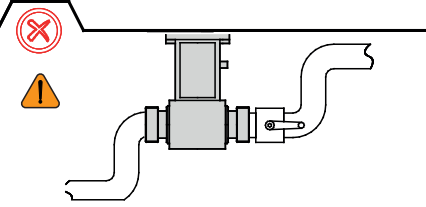
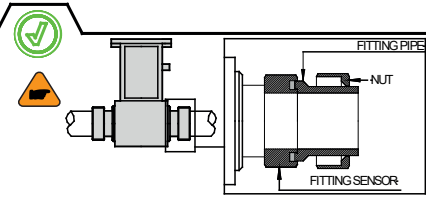
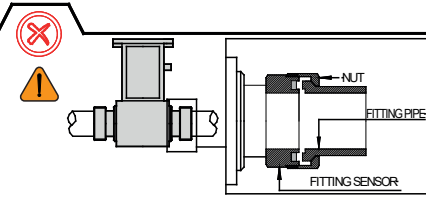
| | |
|--|---|
| <p>In vertical installations an ascending flow is preferable. For vertical installations with descending flow direction contact the manufacturer</p> | |
|  |  |
| <p>For installations in long pipe lines, please use anti vibration joints</p> | |
|  |  |
| <p>Avoid a partially empty pipe, during operation the pipe must be either completely full of liquid or completely empty</p> | |
|  |  |
| <p>Install the sensor away from bends and hydraulic accessories</p> | |
|  |  |
| <p>Avoid positioning fittings by tightening the clamps.</p> | |
|  |  |

OVERALL DIMENSIONS

GAS/NPT WITHOUT LINING

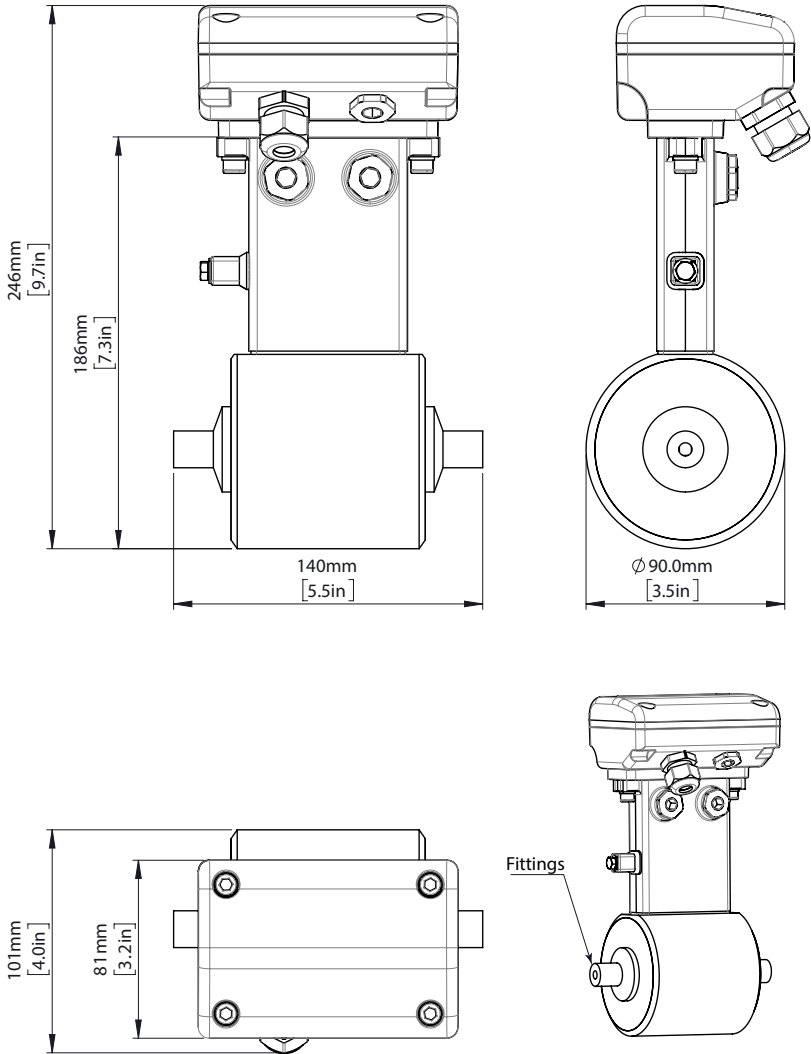

| CONNECTIONS GAS/NPT | | | | | |
|-------------------------------|-----------|---------|----------|-----------|-----------|
| DIMENSIONS mm (inches) | DN | | | | |
| | 3 (1/8") | 6 (1/4) | 10 (3/8) | 15 (1/2") | 20 (3/4") |
| FITTINGS | 1/4" | 3/8" | 1/2" | 3/4" | 1" |

GROUNDING INSTRUCTIONS



For correct operation of the meter is **NECESSARY** that the sensor and the liquid are equipotential, so **ALWAYS** connect the sensor and converter to ground:

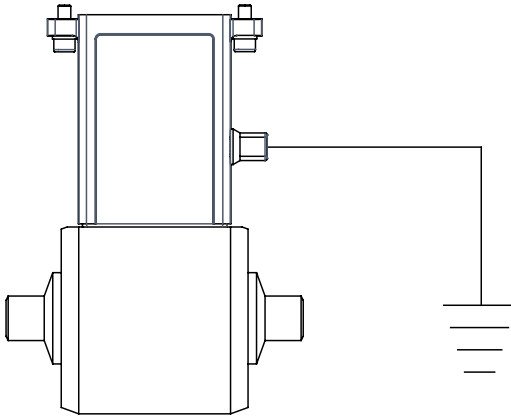

OPERATIVE TEMPERATURE

| LIQUID TEMPERATURE | AMBIENT TEMPERATURE |
|------------------------------|------------------------------|
| 0 °C ÷ 60 °C 32°F ÷ 140°F | 0 °C ÷ 60 °C 32°F ÷ 140°F |

At the end of its lifetime, this product shall be disposed of in full compliance with the environmental regulations of the state in which it is located.

MANUAL REVIEWS

| REVIEW | DATE | DESCRIPTION |
|------------------------|-------------|--------------------------------------|
| MAN_MS600_EN_IT_NL_R01 | 25/05/2021 | INTEGRATION: NOMENCLATURE UPDATED |
